



# CoreLine Projector gen2

## ST151T LED30S/940 WB WH

38 ° - 940 neutral white - Power supply unit - White

The well-known CoreLine Projector with its latest generation has undergone important design and performance improvement, raising the bar even higher and setting a new standard for track projectors used in retail and hospitality applications.

### Warnings and Safety

- The luminaire should be mounted outside of arm's reach
- The luminaire should be installed by a qualified electrician and wired in accordance with the latest IEE electrical regulations or the national requirements

### Product data

General Information			
Beam angle of light source	38 °	Flammability mark	NO [ - ]
Light source colour	940 neutral white	CE mark	CE mark
Light source replaceable	No	ENEC mark	ENEC mark
Number of gear units	1 unit	Warranty period	5 years
Driver/power unit/transformer	PSU [ Power supply unit ]	Constant light output	Yes
Driver included	Yes	Number of products on MCB (16 A type B)	30
Optic type	Beam angle 38°	Photobiological risk	Photobiological risk group 0 @ 200mm to EN62471
Luminaire light beam spread	38°	Photobiological risk specification	0.2 m
Control interface	-	EU RoHS compliant	Yes
Connection	Track	Unified glare rating CEN	20
Cable	-		
Protection class IEC	Safety class I		
Glow-wire test	Temperature 650 °C, duration 30 s		

CoreLine Projector gen2

Light Technical	
Saturated Red	>50
Operating and Electrical	
Input Voltage	220 to 240 V
Input frequency	50 or 60 Hz
Initial CLO power consumption	27 W
Average CLO power consumption	27 W
Inrush current	43.8 A
Inrush time	0.0115 ms
Power factor (min.)	0.9
Controls and Dimming	
Dimmable	No
Mechanical and Housing	
Housing material	Aluminium
Reflector material	-
Optic material	Polycarbonate
Optical cover/lens material	Polycarbonate
Fixation material	-
Optical cover/lens finish	-
Overall length	207 mm
Overall width	87 mm
Overall height	125 mm
Overall diameter	80 mm
Colour	White
Dimensions (height x width x depth)	125 x 87 x 207 mm (4.9 x 3.4 x 8.1 in)
Approval and Application	
Ingress protection code	IP20 [ Finger-protected]
Mech. impact protection code	IK03 [ 0.3 J]
Sustainability rating	-

Initial Performance (IEC Compliant)	
Initial luminous flux (system flux)	3000 lm
Luminous flux tolerance	+/-10%
Initial LED luminaire efficacy	110 lm/W
Init. Corr. Colour Temperature	4000 K
Init. Colour rendering index	>90
Initial chromaticity	(0.3837, 0.3828) SDCM <4
Initial input power	27 W
Power consumption tolerance	+/-10%
Over Time Performance (IEC Compliant)	
Control gear failure rate at median useful life	0.05 %
50,000 h	
Lumen maintenance at median useful life*	L70
50,000 h	
Application Conditions	
Ambient temperature range	-20 to +40 °C
Performance ambient temperature Tq	25 °C
Maximum dimming level	Not applicable
Suitable for random switching	No
Product Data	
Full product code	871951452862899
Order product name	ST151T LED30S/940 WB WH
EAN/UPC – product	8719514528628
Order code	52862899
SAP numerator – quantity per pack	1
Numerator – packs per outer box	10
SAP material	911401847282



Dimensional drawing

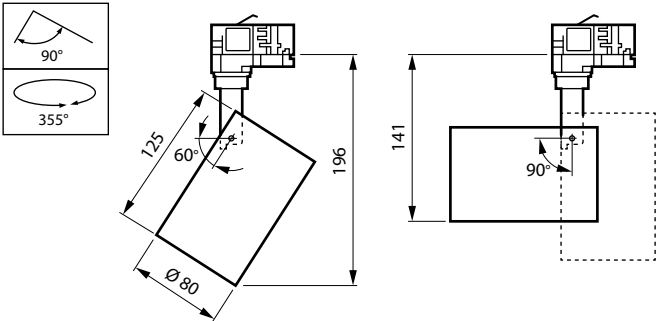

ST151T LED30S/940 WB WH

Photometric data

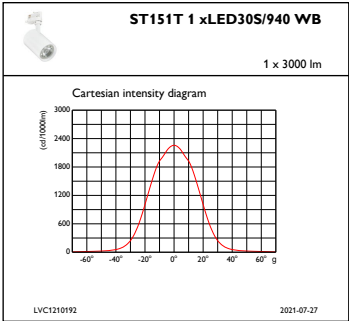

IFCC1\_ST151T1xLED30S940WB

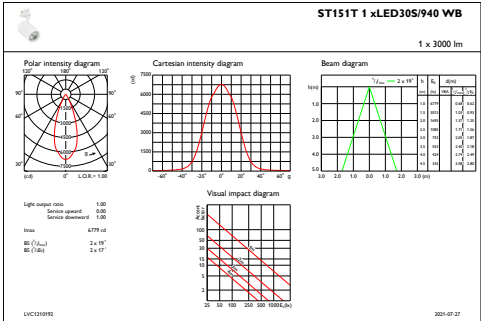

IFAS1\_ST151T1xLED30S940WB

